

WEEKLY PROGRAMMABLE ELECTRONIC TIMER

- DIN Rail Installation
- Advanced pre-setting one week before
- Latest technology COMS quartz Mico-controller
- Digital electronics general purpose time swich with daily and weekly programs
- Repeat programs with 8 ON/OFF settings.
- To-the-minute setting accuracy.
- LCD displays real time to Hour/Minute and ON/AUTO/OFF.

TECHNICAL DATA

- | | |
|--|---|
| ● Voltage limit: AC180V ~ 264V (50/60Hz) | ● Number of circuits: 1c |
| ● Hysteresis: < 2s/d (at25°C) | ● Load capacity: 16A 250VAC (ohmic load $\cos \phi=1$) |
| ● On/off operation: 8on & 8off | ● Service life: Mechanically: 10 ⁷ |
| ● Minimum interval: 1 minute | Electrically: 10 ⁵ |
| ● Weight: Approx 150g | ● Ambient temperature: -10~55°C |
| ● Display: LCD | ● storage temperature: -20~70°C |
| ● Battery backup: 150h | ● Power consumption: 5VA |

8A cos φ = 0.6

DIMENSIONS

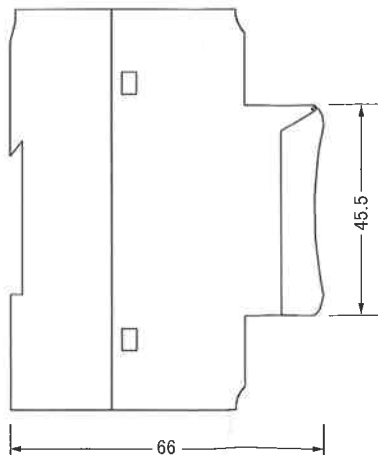
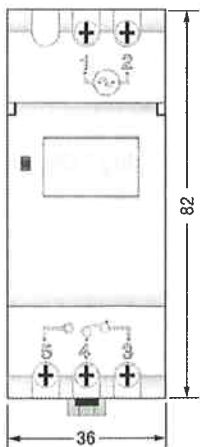

CONNECTIONS

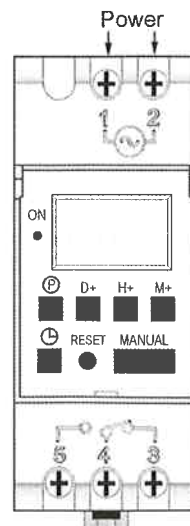

■ OPERATING INSTRUCTION:

1. First time use this timer switch, please input power and let battery recharge .after then press reset key.
2. At first time, the timer switch is in 24h mode .If you want change to 12h mode please press on "⌚" key 5 sec .and LCD will display AM If you want rechang to 24h mode ,and press on "⌚" key 5 sec to return.

3. Programming :

Step	Key	Programming
1	Press P	Setting 1 ON time (display 1 on)
2*	Press D+	Select days of week (If you want same set in every day,you need not press this key)
3	Press H+/ M+	Set hours and minutes
4	Press P	Setting 1 off time , display 1 off)
5	Press D+	Select days of week (If you want same set in every day,you need not press this key)
6	Press H+/ M+	Set hours and minutes
7	Repeat step 2-6	Set 2-8 on/off time
8**	Press ⌚	End

For cancel engagements , press "MANUAL " then "- :- -" is displayed on LCD to confirm cancel

May press "MANUAL " again to resume initial setting.

*10 deferent mode : (1.MO 2.TU 3. WE 4. TH 5. FR 6. SA 7. SU 8. MO TU WE TH FR 9. SA SU
10. MO TU WE TH FR SA SU)

**IF you need not 8 time setting press"⌚" key to the end

4. CLOCK SETTING

- (1) Press "⌚" and "D+" together till correct date is shown.
- (2) Press "⌚" and "H+" together till correct hour is shown.
- (3) Press "⌚" and "M+" together till correct min is shown.
- (4) Press "MANUAL " key to display ON AUTO or AUTO OFF. (If this clock in your program is ON selects ON AUTO ,and this clock in your program is OFF selects AUTO OFF)

5. If you always want to use time switch ON or OFF,Please Press "MANUAL "key to display "ON" or "OFF".

■ NOTE:

THE POWER CONSUMPTION OF CONNECTED ELECTRICAL APPLIANCES, SHALL BE WITHIN .
THE LIMITATION OF FOLLOWING RATED CAPACITY.